

RECOMMENDED PCB LAYOUT

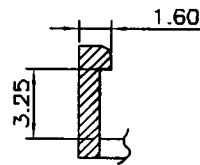
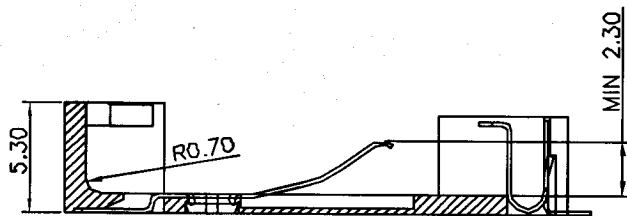

SECTION B-B

NOTES:

1. DIMENSIONS ARE IN MILLIMETER
2. MATERIAL:
 PLASTIC PART: PPS+30%G.F
 UL94V-0, BROWN;
 CONTACT: PHOSPHOR BRONZE
3. FINISH:
 CONTACT: GOLD PLATED ALL OVER THE FACE
4. ACCORDING TO THE ENVIRONMENTAL REQUIREMENT, WARRANTY THE CONTROLLED HAZARDOUS SUBSTANCE SHOULD BE MEET ROHS'S SPECIFICATION.

SECTION A-A

3		COMF COMFORTABLE ELECTRONIC CO.LTD.		
2		NAME CH 7410-2032LF		
1		SCALE 1:1	APPD. <i>khvigin</i>	
NO.	DATE	UNIT MM	CHKD. <i>khvigin</i>	
General Tolerances: Angel: $\pm 1^\circ$ Dim: 0.0 ± 0.40 0.00 ± 0.25 0.000 ± 0.13		MAT'L	DWN.	LING
		DATE 02/12/04	DR NO.	CH 2032-0204