

**MATERIAL**

Contact Pin : Brass

**SPECIFICATION**

Current Rate : 3 AMP

Insulation Resistance : 5000MΩMin. at DC 500V

Contact Resistance : 20mΩMax. at DC 100mA

Dielectric Voltage : AC 500V for one minute

Operation Temperature : -40°C to + 105°C

216-7 1- 36 G B 02  
 1 2 3 4 5 6

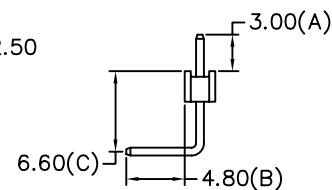
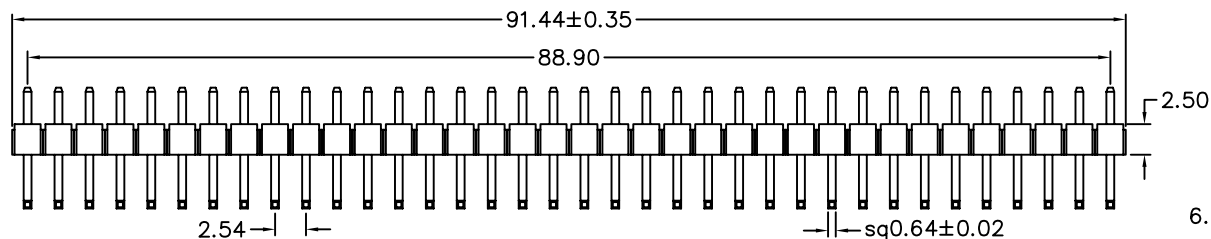

- 1. 5: Normal parts (30% Glass fiber PBT)
- 7: Green Product (30% Glass fiber PBT)
- 9: Green Product High Temp (NYLON 9T)
- 2. 1: Single row
- 2: Dual rows
- 3. No. of contacts per row
- 4. G: Gold flash
- S: Selective
- T: Tin plated
- 5. B: Black Insulator
- 6. Pinrex internal code.

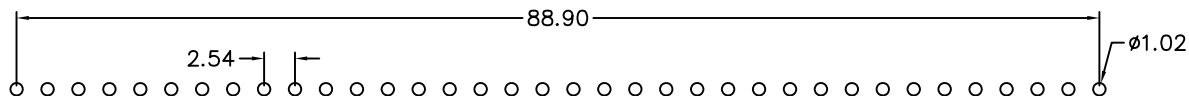

Recommended P.C.B Layout

				TOLERANCE .0 =±.30 .00 =±.20 .000 =±.XXX .0000=±. ANG.=±3°		 UNITS : mm		OLD PART NO. PH1R0-136GB 30/48/66 DRAWER <i>Naomi</i>		CHECK		TITLE PIN HEADER 2.54*2.54mm RIGHT ANGLE TYPE, SINGLE ROW OPPOSITE INSULATOR		頻銳科技股份有限公司 PINREX TECHNOLOGY CORP.		
A	RELEASE	2008/04/03		SCALE	SIZE	SHEET	REV.	APP'D	NEW PART NO.		DRAW NO.		216-71-36GB02		216-71-36GB02	
REV.	DESCRIPTION	DATE		NONE	A4	1 OF 1	<b>A</b>		216-71-36GB02							