

REV.	DESCRIPTION	DRAWN	ECN	DATE
A	NEW RELEASE	ANGELA	99-281	08-27'99

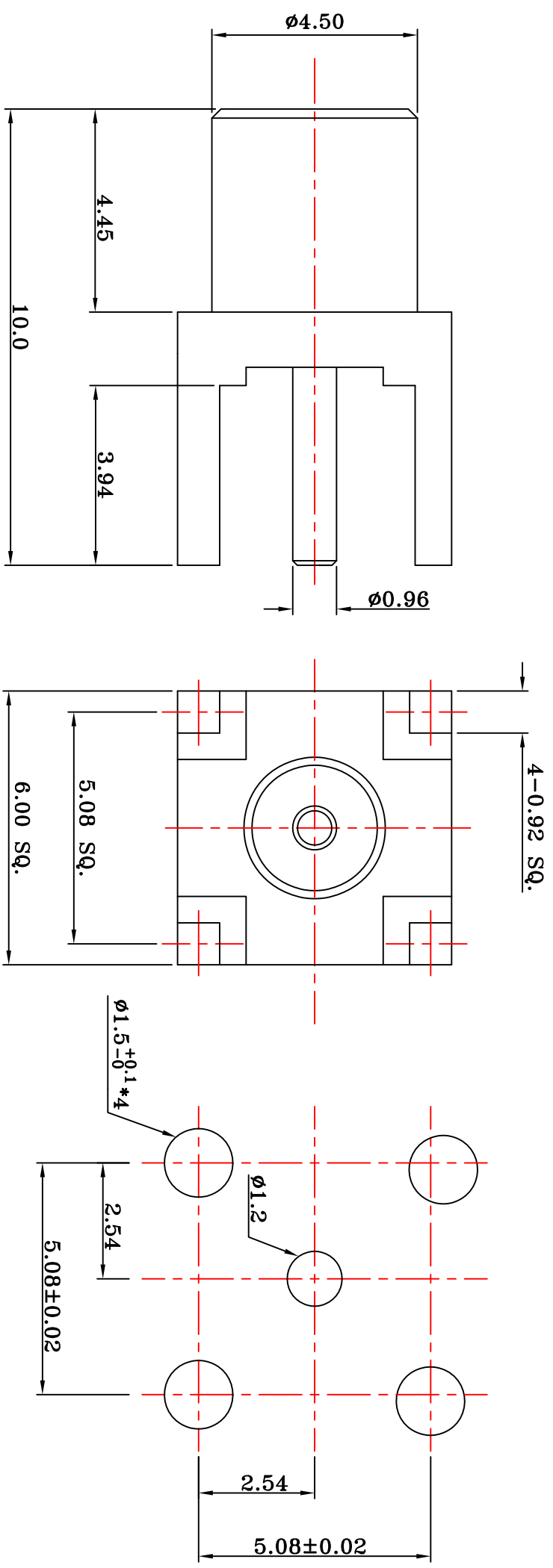

RECOMMENDED  
PCB HOLD

- ELECTRICAL RATINGS :**
1. IMPEDANCE : 50 Ohms
  2. FREQUENCY RANGE : 0~6 GHz
  3. WORKING VOLTAGE : 335 Vrms MAX
  4. DIALECTRIC WITHSTANDING VOLTAGE : 1000 Vrms MAX
  5. VSWR: 1.35MAX

UNLESS OTHERWISE SPECIFIED ALL TOLERANCES ARE:

DIMENSION	DIMENSIONS	ANGLE	DIMENSIONS
INTEGRAL	±1.0	ANGULAR	±5.0°
1 PLACE	±0.5	HOLES UNDER	±0.5
2 PLACE	±0.25	ROUGHNESS	±0.1



Precise Corp.

DRAWN BY:	ANGELA	DATE:	08-27'99
ENGR BY:	ANGELA	DATE:	08-27'99
APVD BY:		DATE:	

DESCRIPTION	MATERIALS	FINISHED
CONTACT	BF.COPPER	GOLD 30u"
INSULATOR	TEFLON	NONE
BODY	BRASS	GOLD
DESCRIPTION	MATERIALS	FINISHED

TITLE: **MCMX STRAIGHT JACK PCB RECEPTACLE**  
Model No: X106-000A

Drawing No:	X106-000A
UNIT:	MM
SCALE:	8:1
SHEET:	1 OF 1
REV.:	A
CAD FILE:	Z\sales\MCMX

**RoHS**  
COMPLIANT  
2002/95/EC