



Products

Signal lights ø 8-10 | 33 series



33 Series

- Voltage: from 24V to 400V
- Ambient temperature: from T70 °C to T150 °C
- Panel cut out: ø 10 mm
- Panel thickness: 0.8 - 2.0 mm
- Parallel resistor: on request
- Anti-rotation rib: on request
- Fitting methods: plastic clips
- 

Special feature

- Further lens styles available
- LED version available on request

Dimensions (mm)

Connections



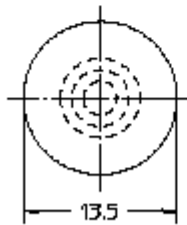
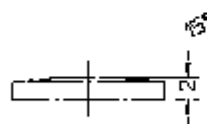
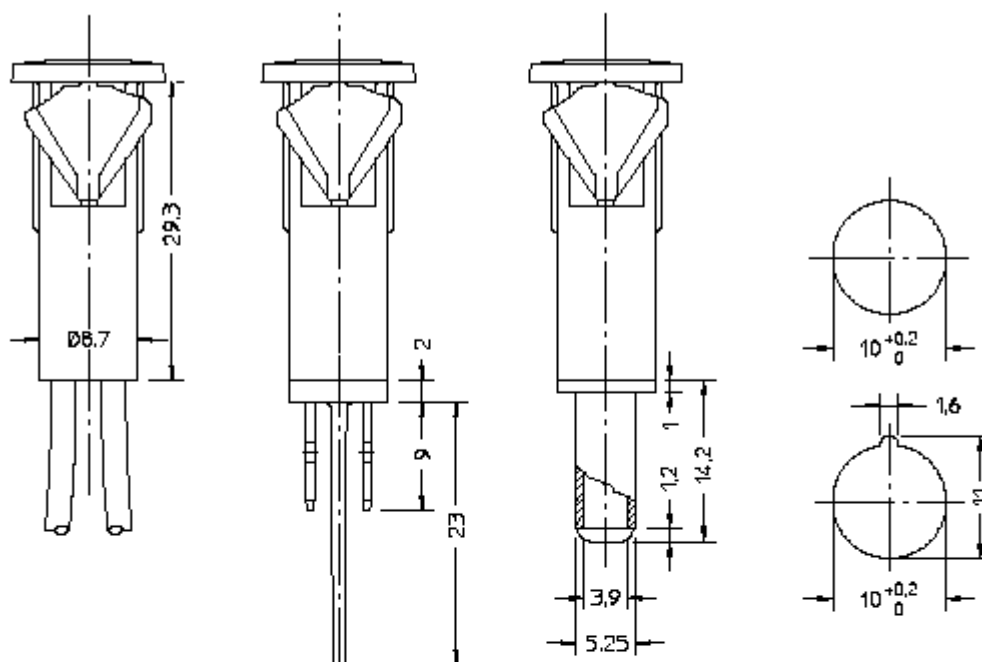

LOW PROFILE LENS
N° 33.2

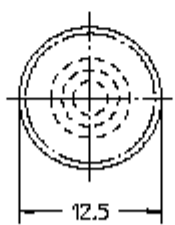
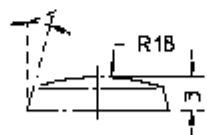

HIGH PROFILE LENS
N° 33.5

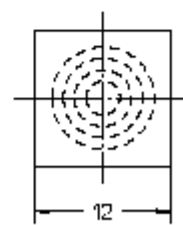
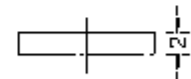

SQUARE LENS
N° 33.4

Configuration examples

