

# CAMBLOCK PLUS

## 3.5mm Pitch Pluggable Rising Clamp Terminal Blocks

- 2-12 pole solid block
- Pluggable male-female connectors
- Closed headers
- Polarised mouldings
- Moulded in green UL94-V0 flame retardant PA66
- Professional rising clamp terminals
- 1.0mm<sup>2</sup> (28-16AWG) solid & stranded cable
- Anti solder wicking
- Captive screws
- Guided pin alignment
-  approved

### SPECIFICATION

Rating	UL=8A/300V, VDE=10A/250V
Insulation resistance	500MΩ/500V
Withstand Voltage	AC2000V/1min
Contact Resistance	20mΩ (max)
Working Temperature	-40°C to 105+°C
Mouldings	UL94-V0 Flame retardant PA66
Pin/Terminal	Tin plated brass
Rising Clamp	Brass, nickel plated
Screw/Torque	M2 Steel, zinc Plated 0.2Nm
Recommended PCB hole size	ø1.4mm

### Female Connector

CTBP92HD

TYPE NO.	POLES	LENGTH
CTBP92HD/2	2	7.8mm
CTBP92HD/3	3	11.3mm
CTBP92HD/4	4	14.8mm
CTBP92HD/5	5	18.3mm
CTBP92HD/6	6	21.8mm
CTBP92HD/7	7	25.3mm
CTBP92HD/8	8	28.8mm
CTBP92HD/9	9	32.3mm
CTBP92HD/10	10	35.8mm
CTBP92HD/11	11	39.3mm
CTBP92HD/12	12	42.8mm

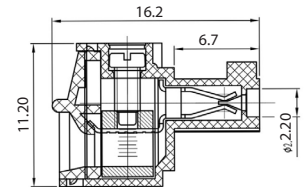
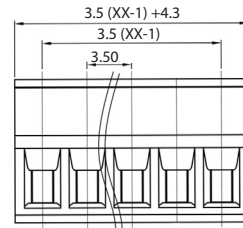
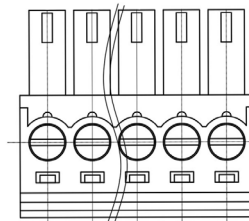

### Female Connector Vertical (standard)

CTBP92VD/S

TYPE NO.	POLES	LENGTH
CTBP92VD/2S	2	7.8mm
CTBP92VD/3S	3	11.3mm
CTBP92VD/4S	4	14.8mm
CTBP92VD/5S	5	18.3mm
CTBP92VD/6S	6	21.8mm
CTBP92VD/7S	7	25.3mm
CTBP92VD/8S	8	28.8mm
CTBP92VD/9S	9	32.3mm
CTBP92VD/10S	10	35.8mm
CTBP92VD/11S	11	39.3mm
CTBP92VD/12S	12	42.8mm

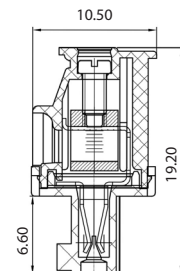
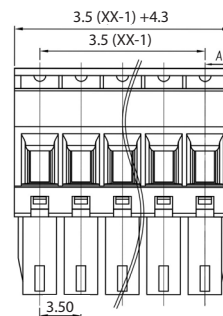
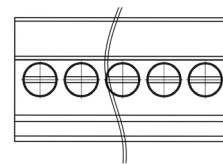

# CAMBLOCK PLUS

## Female Connector Vertical (reversed)

TYPE NO.	POLES	LENGTH	CTBP92VD/R
CTBP92VD/2R	2	7.8mm	
CTBP92VD/3R	3	11.3mm	
CTBP92VD/4R	4	14.8mm	
CTBP92VD/5R	5	18.3mm	
CTBP92VD/6R	6	21.8mm	
CTBP92VD/7R	7	25.3mm	
CTBP92VD/8R	8	28.8mm	
CTBP92VD/9R	9	32.3mm	
CTBP92VD/10R	10	35.8mm	
CTBP92VD/11R	11	39.3mm	
CTBP92VD/12R	12	42.8mm	

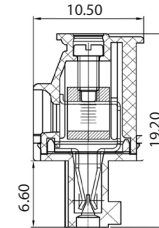
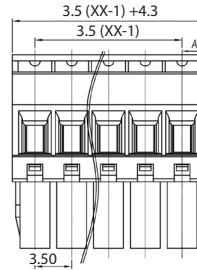
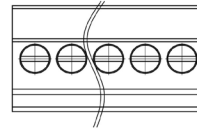

## PCB Mounting Male Horizontal (closed ended)

TYPE NO.	POLES	LENGTH	CTBP93HD
CTBP93HD/2	2	8.4mm	
CTBP93HD/3	3	11.9mm	
CTBP93HD/4	4	15.4mm	
CTBP93HD/5	5	18.9mm	
CTBP93HD/6	6	22.4mm	
CTBP93HD/7	7	25.9mm	
CTBP93HD/8	8	29.4mm	
CTBP93HD/9	9	32.9mm	
CTBP93HD/10	10	36.4mm	
CTBP93HD/11	11	39.9mm	
CTBP93HD/12	12	43.4mm	

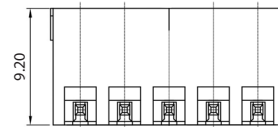
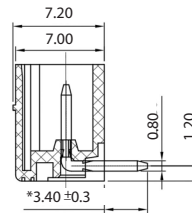
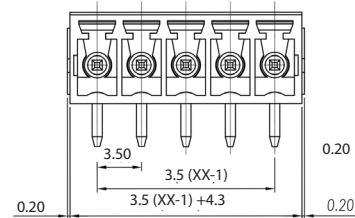

## PCB Mounting Male Vertical (closed ended)

TYPE NO.	POLES	LENGTH	CTBP93VD
CTBP93VD/2	2	8.4mm	
CTBP93VD/3	3	11.9mm	
CTBP93VD/4	4	15.4mm	
CTBP93VD/5	5	18.9mm	
CTBP93VD/6	6	22.4mm	
CTBP93VD/7	7	25.9mm	
CTBP93VD/8	8	29.4mm	
CTBP93VD/9	9	32.9mm	
CTBP93VD/10	10	36.4mm	
CTBP93VD/11	11	39.9mm	
CTBP93VD/12	12	43.4mm	

